

<p>NPN型 低频放大 小功率 贴片三极管 NPN Plastic-Encapsulate Transistors SMD</p>	
<ul style="list-style-type: none"> <li>■ High breakdown voltage</li> <li>■ Low collector-emitter saturation voltage</li> <li>■ Transistor Polarity: NPN</li> <li>■ Transistor pinout: BEC</li> <li>■ SOT-23 Package</li> <li>■ Marking Code: J3Y</li> </ul>	<p><b>S8050</b></p> <p>对应其他工业型号</p>

<p>Inner circuit</p>  <p>SOT-23 内部结构</p>	<p>S8050B</p>  <p>SOT-23 管脚排列</p>	<p>元件标识 (打印)</p>  <p>DEVICE MARKING</p>
--	---	---

■ CLASSIFICATION OF hFE

RANK	L	H
RANGE	100~200	200~300

■ MAXIMUM RATINGS

Parameter	Symbol	Value	Unit
Collector-Base Voltage	$V_{CB0}$	40	V
Collector-Emitter Voltage	$V_{CE0}$	25	V
Emitter-Base Voltage	$V_{EB0}$	5	V
Collector Current	$I_c$	350	mA
Collector Power Dissipation	$P_c$	300	mW
Operation Junction and Storage Temperature Range	$T_J, T_{stg}$	-55~+150	°C

**■ ELECTRICAL CHARACTERISTICS (T<sub>A</sub>=25°C unless otherwise noted )**

Characteristic	Test Condition	Symbol	Min	Typ	Max	Unit
Collector Cutoff Current	V <sub>CB</sub> =40V, I <sub>E</sub> =0	I <sub>CBO</sub>	--	--	0.1	μA
Emitter Cutoff Current	V <sub>EB</sub> =5V, I <sub>C</sub> =0	I <sub>EBO</sub>	--	--	0.1	μA
Collector-Base Breakdown Voltage	I <sub>E</sub> =0 I <sub>C</sub> =100μA	V <sub>(BR)CBO</sub>	40	--	--	V
Collector-Emitter Breakdown Voltage	I <sub>E</sub> =0 I <sub>C</sub> =10mA	V <sub>(BR)CEO</sub>	25	--	--	V
Emitter Cutoff Current	I <sub>C</sub> =0, I <sub>E</sub> =100μA	V <sub>(BR)EBO</sub>	5	--	--	V
DC Current Gain	I <sub>C</sub> =100mA, V <sub>CE</sub> =1V	hFE (1)	85	--	400	
	I <sub>C</sub> =350mA, V <sub>CE</sub> =1V	hFE	40	--	--	
Collector-Emitter Saturation Voltage	I <sub>C</sub> =350mA, I <sub>B</sub> =50mA	V <sub>CE(sat)</sub>	--	--	0.6	V
Base-Emitter Voltage	V <sub>CE</sub> =1V, I <sub>C</sub> =10mA	V <sub>CE(sat)</sub>	--	0.8	1.0	V
Current-Gain-Bandwidth Product	V <sub>CE</sub> =5V, I <sub>C</sub> =10mA	f <sub>T</sub>	100	120	--	MHz
Collector Output Capacitance	V <sub>CB</sub> =10V, I <sub>E</sub> =0, f=1MHz	C <sub>ob</sub>	--	13	30	pF

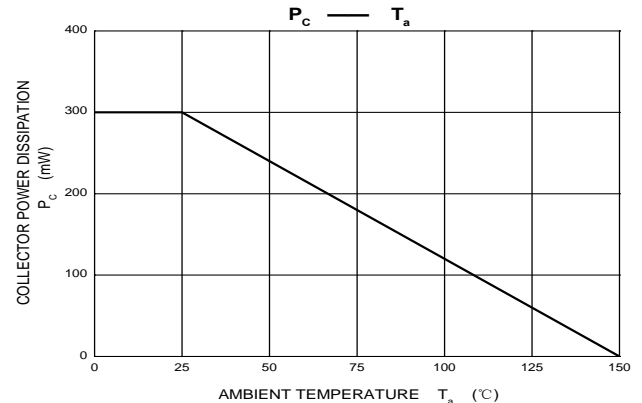
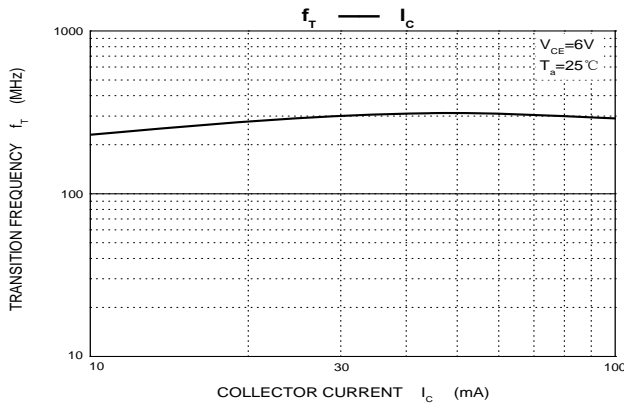
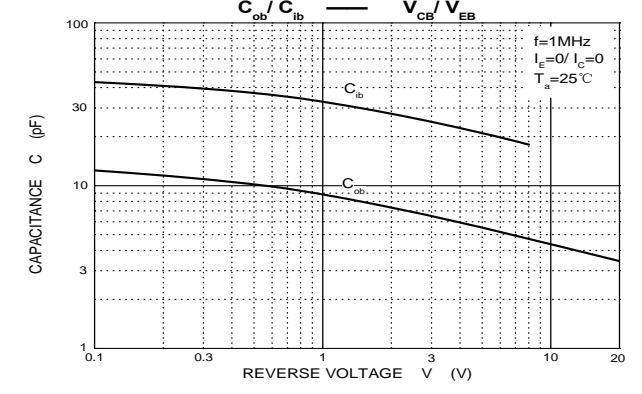
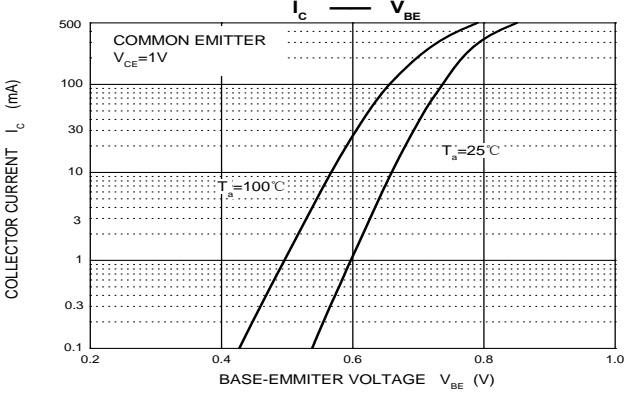
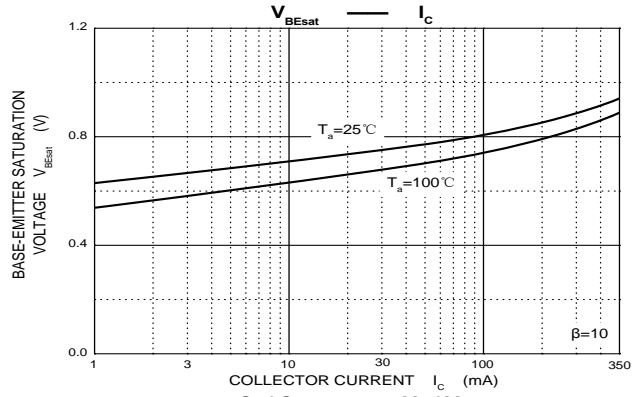
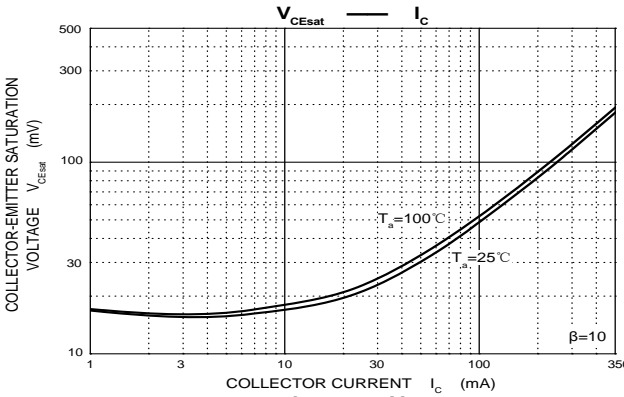
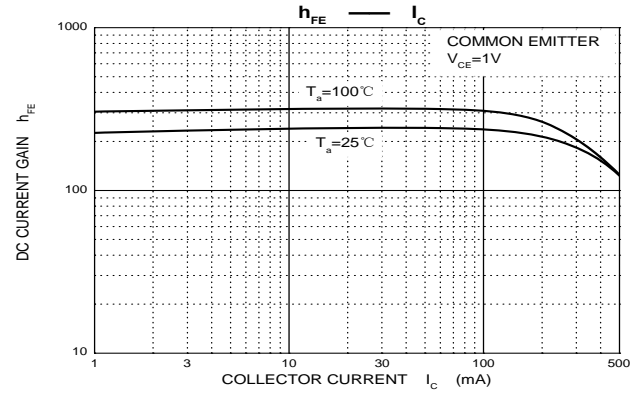
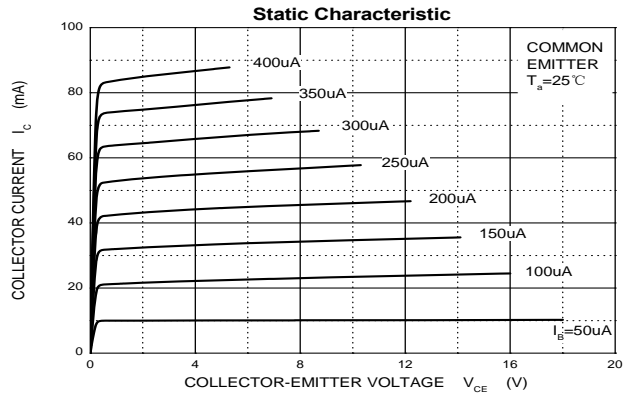

■ DIMENSION

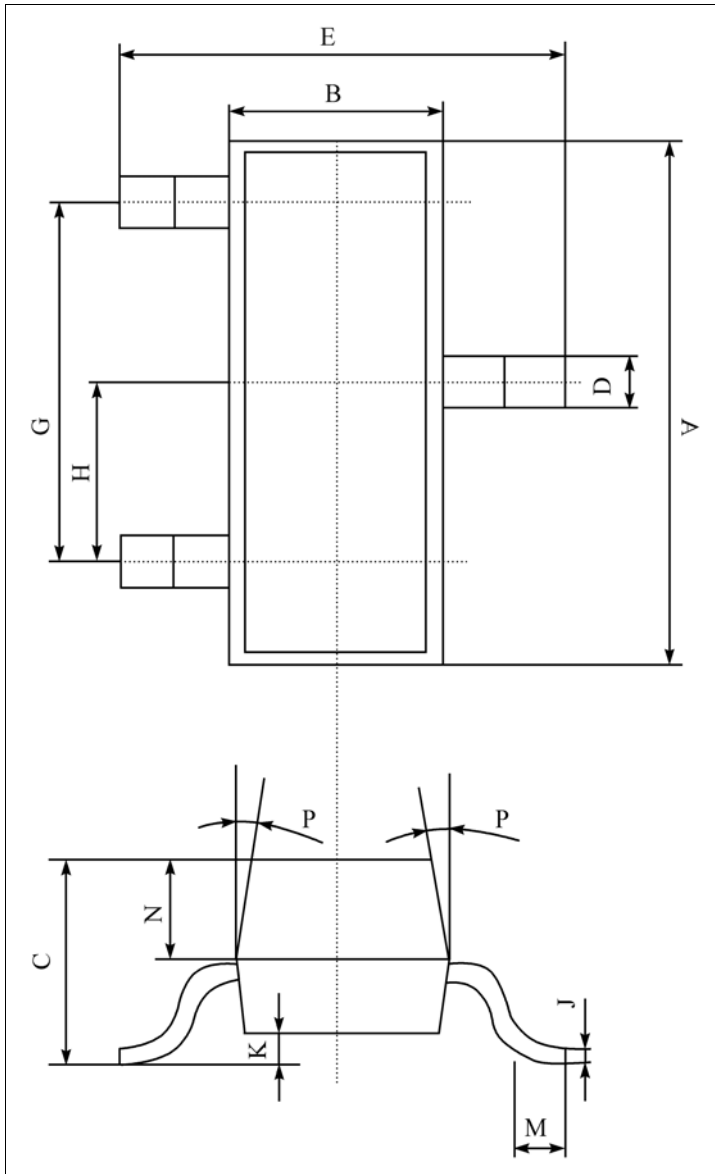

单位 (UNIT) : mm

序号	数值及公差
A	2.90±0.10
B	1.30±0.10
C	1.00±0.10
D	0.40±0.10
E	2.40±0.20
G	1.90±0.10
H	0.95±0.05
J	0.13±0.05
K	0.00-0.10
M	≥0.20
N	0.60±0.10
P	7±2°

**Packing**  
 SOT-23 包装规格  
 SMD片式表面贴封装  
 包装方式: 载带卷盘包装  
 Tape & Reel, 3Kpcs/Reel  
 每卷数量3000只 (3Kpcs/Reel)  
 每盒数量45000只 (45Kpcs/BOX)  
 每箱数量180000只 (180Kpcs/Cartons)

### SOT-23 Tape and reel

SOT-23 Embossed Carrier Tape

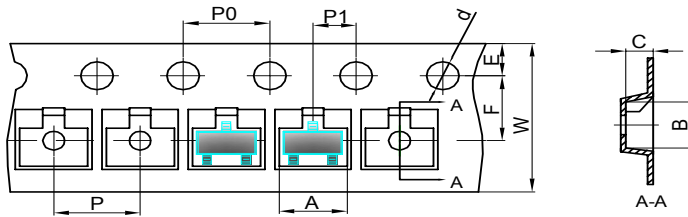

Dimensions are in millimeter											
Pkg type	A	B	C	d	E	F	P0	P	P1	W	
SOT-23	3.15	2.77	1.22	Ø1.50	1.75	3.50	4.00	4.00	2.00	8.00	

### SOT-23 Tape Leader and Trailer

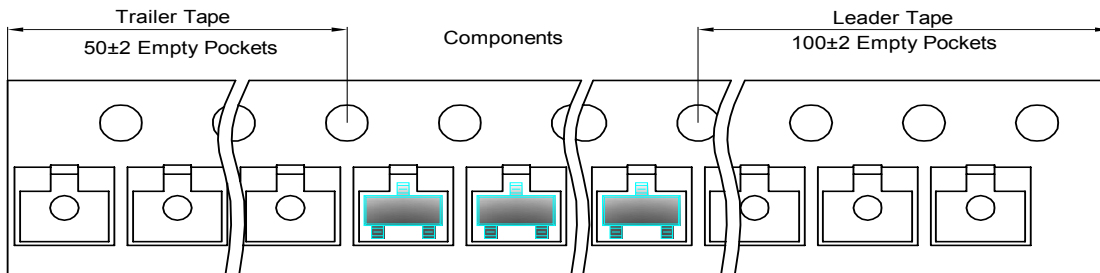

### SOT-23 Reel

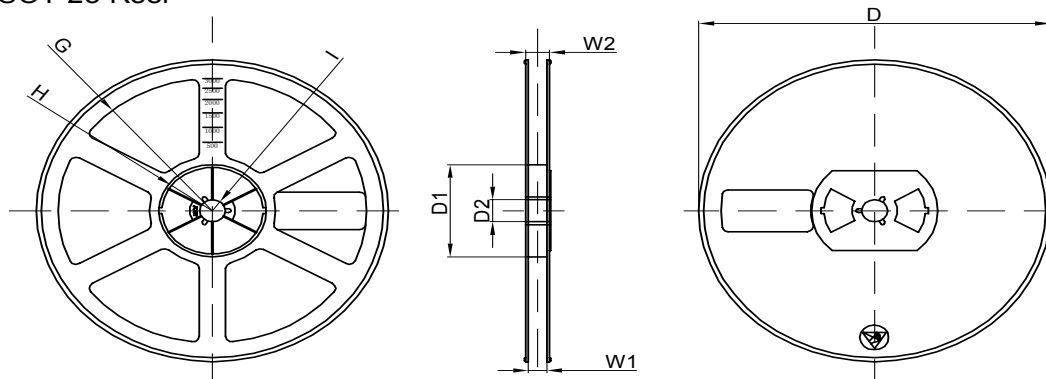

Dimensions are in millimeter								
Reel Option	D	D1	D2	G	H	I	W1	W2
7" Dia	Ø178.00	54.40	13.00	R78.00	R25.60	R6.50	9.50	12.30

REEL	Reel Size	Box	Box Size(mm)	Carton	Carton Size(mm)	G.W.(kg)
3000 pcs	7 inch	45,000 pcs	192×192×193	180,000 pcs	404×404×214	